

# Dialogic

## Dialogic® IMG/MSP 1010 TECH NOTE

### Installing a VoIP or Media Module

**Follow this procedure to add a VoIP or Media module on the IMG or MSP.**

**Caution:**

Electrostatic Discharge Protection (EDP) must always be used. Electrostatic Discharge (ESD) protective straps, shoes, or mats must be used when working with electronic components. Electrostatic discharge from your body can damage integrated circuits during installation.

**Required Tools and Parts**

- VoIP Module or Media Module (Dialogic supplied).
- 4 Phillips pan head screws (Dialogic supplied).
- #1 Phillips head screwdriver (customer supplied).

**Steps**

1. Set power to OFF (O) at rear of docking station.
2. Remove Motherboard Tray. See [Diagram 1 - Removing Motherboard Tray](#).
  - a. Loosen the two ejector captive fasteners located on each side of the front panel.
  - b. Lift the ejectors upward and pull to unseat the tray from the docking station.
  - c. Slide the tray out.
3. Locate Module Position. See [Diagram 2 - Module Positions](#).

## Installing a VoIP or Media Module

### 4. Install module on motherboard

- a. Position the module over the four standoffs.
- b. Align the connectors on the module with the connectors on the motherboard and press together. See diagram below

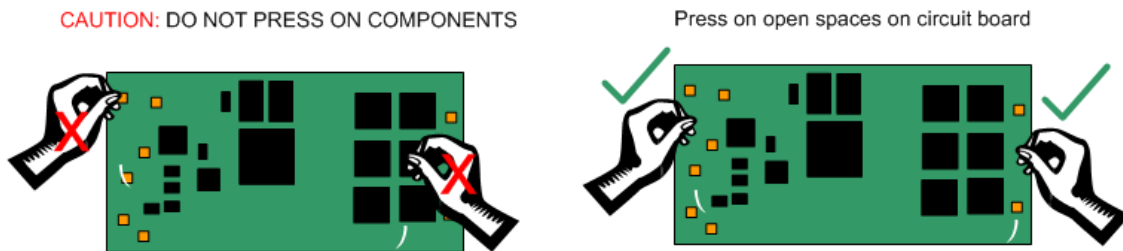

#### Cautions:

- **The connectors must be properly aligned and fully seated, to ensure a trouble-free installation.**
- **When pressing the module onto the motherboard do not press on the components installed on the module, but rather press on an open area on the edge of the Printed Circuit Board itself.**

c. Attach the module with the four (4) Phillips pan head screws. **Caution:** Do not over tighten the screws. (Recommended torque: 3-5 in-lbs (.34-.56 N-M)).

### 5. Re-insert Motherboard Tray

- a. Align the rail on each side of the tray with the guides on the inside of the docking station.
- b. Ensure the ejectors are in the up position.
- c. Slide the tray in until the power connectors and signal connectors initially mate (the ejectors will start to move down).
  - Do not force the tray if any resistance occurs when mating with the docking station. Using undue force could damage the unit.
  - The guides only provide gross alignment to the power and signal connectors. The guide pins on the main board and I/O card are self-aligning and provide exact alignment for the connectors.
  - The tray guides also act as the conduit for any Electrostatic Discharge (ESD) as the tray initially mates with the docking station.
- d. When the tray is seated and the connectors are mated, push the ejectors down and tighten captive fasteners.

## Installing a VoIP or Media Module

6. Set power to ON (1) at rear of docking station.

7. Configure Module. See **Configuring Media** or **Configuring VoIP** in the On-line Help or on the Customer Support web site: <http://excelsupport.dialogic.com/>

### Diagram 1 - Removing Motherboard Tray

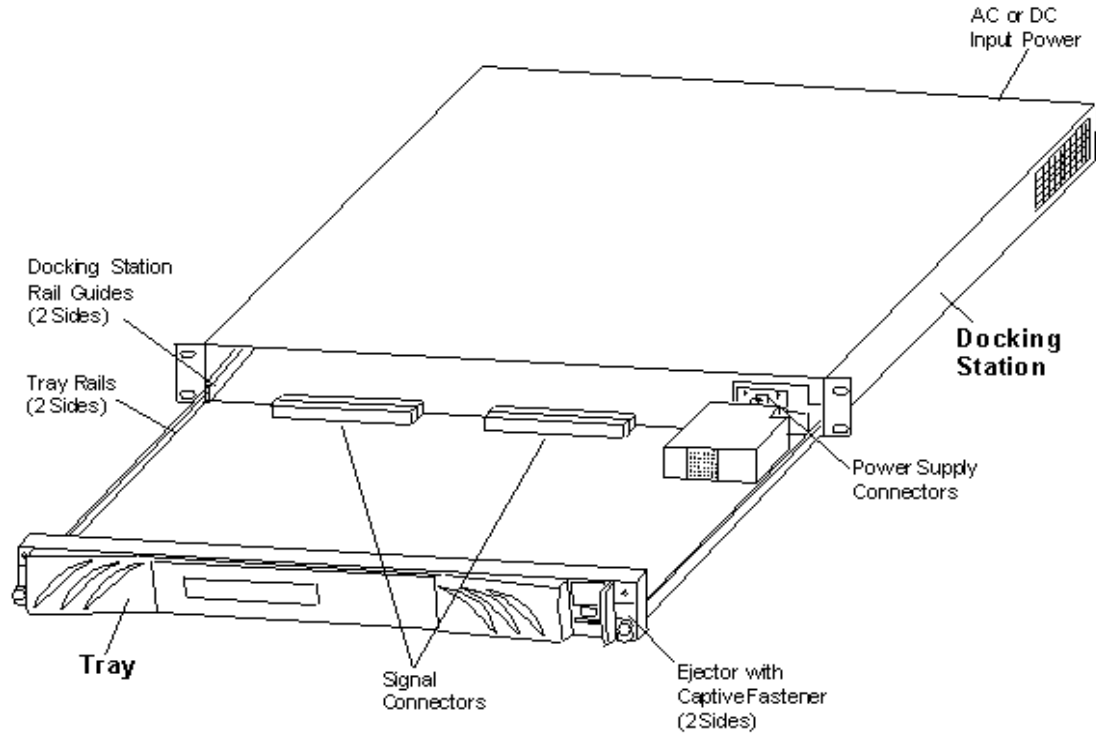

### Diagram 2 - Module Positions

**Important:** If only one VoIP module is to be installed, it must be at Position 0.

